



METAL INDUSTRY Ltd., VRANJE
Radnicka 1, Phone: 017/421-121

Solid fuel stove INOX 75



Instructions for installation and handling



This product meets the requirements of the Ecodesign Directive in terms of efficiency and air pollution level, in order to contribute to the reduction of energy consumption and negative environmental impact.

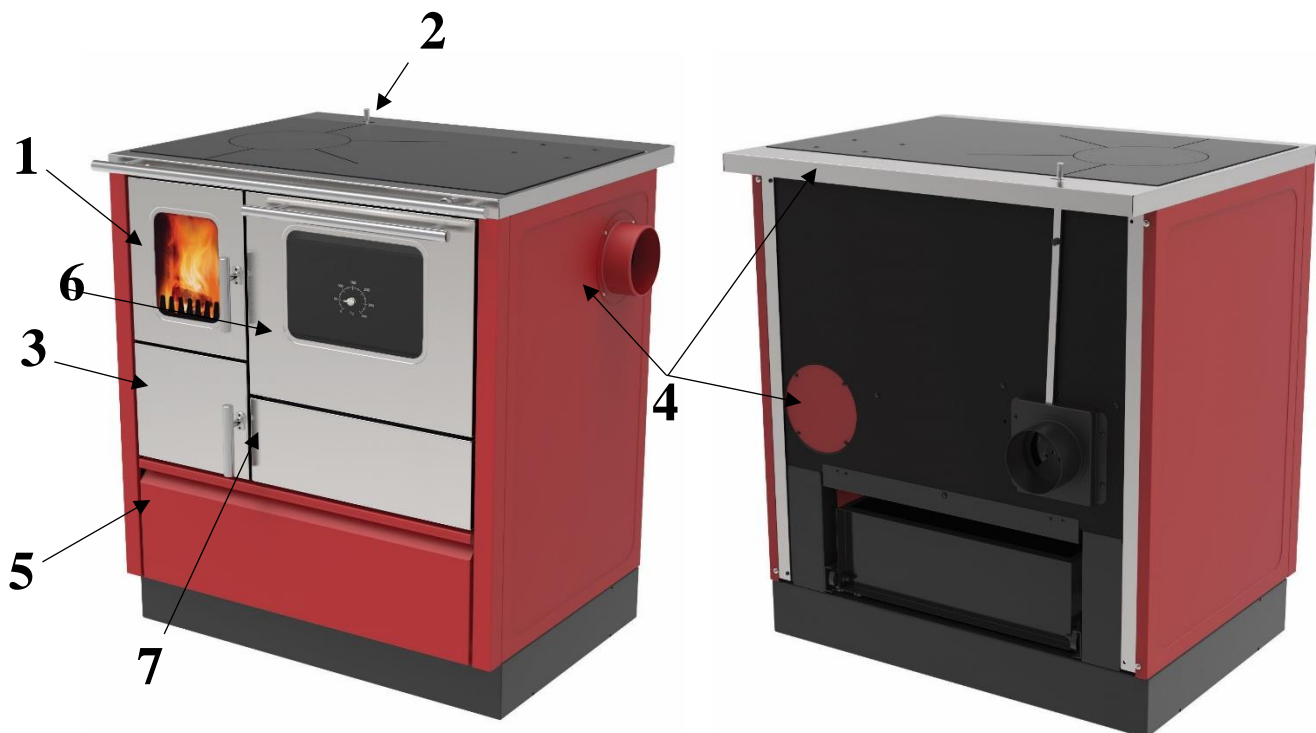

Fig. 1

Solid fuel stove INOX 75

1. Firebox door,
- 2 Slide shutter handle (air control),
- 3 Ashtray cover,
- 4 Flue pipe connection,
- 5 Drawer for dishes,
- 6 Oven door,
7. Cover for the opening for cleaning.

CAUTION!



**SURFACES CAN BE VERY HOT!
ALWAYS USE A PROTECTIVE GLOVE!**

During combustion, thermal energy is released, which significantly influences increasing temperatures of surfaces, doors, handles, glass and exhaust gases. Avoid contact with those elements if you are not wearing protective equipment (including a protective glove). Ensure that children are aware of the risks and keep them away from the stove during operation.

INSTRUCTIONS FOR INSTALLATION, USE AND HANDLING

These instructions for installation, use and handling apply to the following types of stoves:

Inox 75.

In general, one must adhere to the heating regulations in the country, as well as to all necessary local, national and European norms and regulations.

Important prior to use

- * In order to have a properly functioning stove it is important to carefully read these instructions and to precisely follow the guidelines within it.
- * Use only recommended types of fuel, beech wood.
- * The required pressure in the flue, during normal operational load should be ca. 12 Pa. In the case of load above 15 Pa, a damper should be embedded in the flue.
- * You must make sure that the space where the device is placed for stoking gets sufficient supply of fresh air. If the windows and the doors are sealed, or if other devices such as a steam vacuum cleaner, clothes dryer, extractor fan etc. are located in the space where the stove is installed, and they take away the air, then in such circumstances the combustion air (fresh air) should be brought from outside.
Anyway, in that regard, before the installation of the stove you should talk to a competent chimney sweep.
- * No flammable materials should be kept in the ashtray.
The height of ash filling must not exceed the height of the lateral walls of the ash drawer.
- * The door of the firebox and the door of the ashtray must be constantly closed (except during kindling, during fuel filling and when ash is taken out) in order to prevent the escape of flue gases.
- * No components of the stove may be replaced with components other than tested original components and accessories offered by us or our service.
- * In the event of fire in the flue, keep the stove door closed and set the air regulator to zero. Never attempt to extinguish fire in the flue with water.
Abrupt creation of water steam may cause the flue cracking. If necessary, call fire-fighters.

Contents:

1.	TECHNICAL DATA.....	1
2.	INSTALLATION OF THE STOVE.....	1
3.	FLUE INSTALLING.....	1
4.	AIR REGULATION.....	3
4.1.	PRIMARY AIR.....	3
4.2.	HEATING FLAP.....	3
4.3.	OVEN DOOR.....	3
4.4.	Fuel drawer.....	3
5.	STOVE COMMISSIONING.....	4
5.1.	STOKING.....	4
5.2.	COOKING.....	4
5.2.1.	COOKING DURING SUMMER.....	4
5.2.2.	COOKING DURING WINTER.....	4
5.3.	BAKING COOKIES AND BAKING PASTRY.....	4
6.	REMOVAL OF SLAG AND ASH.....	5
6.1.	OPENING FOR CLEANING.....	5
6.2.	MAINTENANCE AND CLEANING OF THE STOVE.....	5
6.3.	MAINTENANCE AND CLEANING OF THE COOKIING PLATE.....	5
7.	GENERAL NOTES.....	5

1. TECHNICAL DATA

	UNIT	INOX 75
Rated heating capacity (kW)	kW	5,9
Temperature of flue gases	°C	159,2
Required pressure in the flue	Pa	12
Dimensions of the stove (width x depth x height)	(mm)	750 x 600 x 850
Dimensions of the oven (width x depth x height)	(mm)	330 x 440 x 260
Diameter of the flue extension	mm	120
Height from the floor to the axis of the flue extension	mm	690
Content CO (13% O ₂)	mg/Nm ³	1455
Efficiency	%	82,5
Weight	kg	110

2. INSTALLATION OF THE STOVE

During the installation of the stove you should pay attention to valid regulations in regard to valid civil engineering and fire prevention regulations and provisions.

The installation of the stove must be performed by a professional installer.

The connection of the stove to the flue is performed from the sides, at the back side and on the top left or right.

This depends on whether you have chosen a 'left' or 'right' stove.

Pay attention to the spot where the stove is installed, it should be horizontal.

If the floor is flammable (wood, plastics, carpet...), you should use steel sheet metal or copper or some other non-flammable material. This base must exceed the basic outlines of the stove by at least 30 cm and on the side where the stove is handled it should exceed this side by 50 cm. The distance between all the sides of the stove and the parts of furniture made of wood or plastics is at least 20 cm, while the distance from the lateral sides must be at least 30cm. Embedded parts made of flammable materials must be at a distance of at least 80cm from the opening for filling the stove towards the sides.

Safe distance for objects that should be protected (walls which might be ignited, walls with components that might be ignited, kitchen cabinets and bearing walls of steel concrete) is at least 20cm, while the distance from the lateral sides must be at least 30cm.

Around the stove, you should provide sufficient distance in relation to flammable objects (that have wooden coating, furniture, curtains etc.).

No upgrading is allowed above the stove, when the steel plate of the stove is used.

When moving the waste gases exhaust pipe, you should keep a minimum distance of 40cm in relation to flammable matters:

Before connecting the stove to the flue you must consult a chimney sweep.

The connection of the stove to the flue is performed with appropriate connection parts according to SRPS.M.R4.031 (DIN 1298. or DIN EN 1856-2).

One must make sure that the connecting joint of the flue, as well as the flue pipe, do not intersect with waste gases and that they are properly sealed.

In general, one should pay attention to DIN 18 160.

For chimney measurement, EN 13 384 applies.

If you want your stove to achieve the desired capacity, you must ensure that the installation is performed properly and above all that the flue functions flawlessly.

In any case, you should check the existing pressure in the flue, prior to commissioning the stove.

The easiest way to control the strength of flue draught is by keeping the flame of a candle under the opening of the flue. The draught is sufficient if the candle flame bends towards the opening of the flue.

Slow bending of the flame is an indicator of poor draught.

If two heating devices are installed on one floor and on one flue (multiple loads) the distance between the connections must not be less than 50 cm.

3. FLUE INSTALLING

If Your flue is not the best or it is with suspicious quality, we recommend that You install a flue connection on the plug carrier (from the top), and not on the side.

The flue reaches its rated power if the flue draft is 12Pa. We recommend the following flue sizes with which this draft is obtained:

- Proper flue and meeting other requirements set out in the material that follows are a prerequisite for flawless functioning of the stove.

- The flue connection should be installed with uplifting.

- Horizontal flue pipe pieces longer than 0,5m should have an uplifting of 10° towards the flue.

- The flue extension, flue pipes and the flue must not be narrowed.

- All connections as well as the flue must be well sealed, with no soot and grime in flue pipes.

- The flue should be protected from cold (it should be heat insulated). This especially applies for flues made of sheet metal and flues built on external walls.

- Flue pipes that do not have thermal insulation and do not stand vertically, must not be longer than 1,25m. Check of the draft strength is performed by using candles (fig. 2).

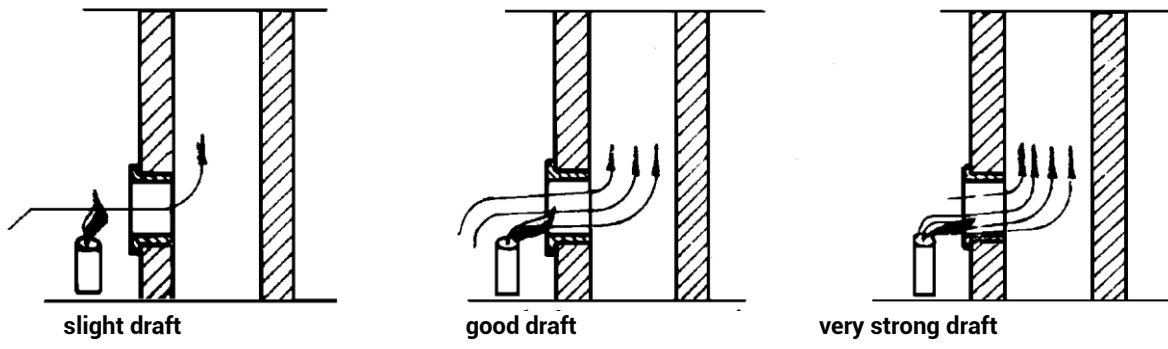

Figure 2

The flue is functioning well if it satisfies the following conditions (fig. 3):

- It protrudes above the roof top (ridge) at least 0,5m.
- It is higher than the neighboring house that is close to the flue, a tree or some other barrier.
- It is in the internal walls of the house or it is well insulated if it is in the external walls.
- The extension should be closely connected to the flue if it is being extended.
- The flue pipe should not be inserted deeply in the flue opening as this reduces the space for smoke output.
- All other unnecessary openings as well as the door for cleaning should be well closed (sealed) so that so called "false" air would not be created.

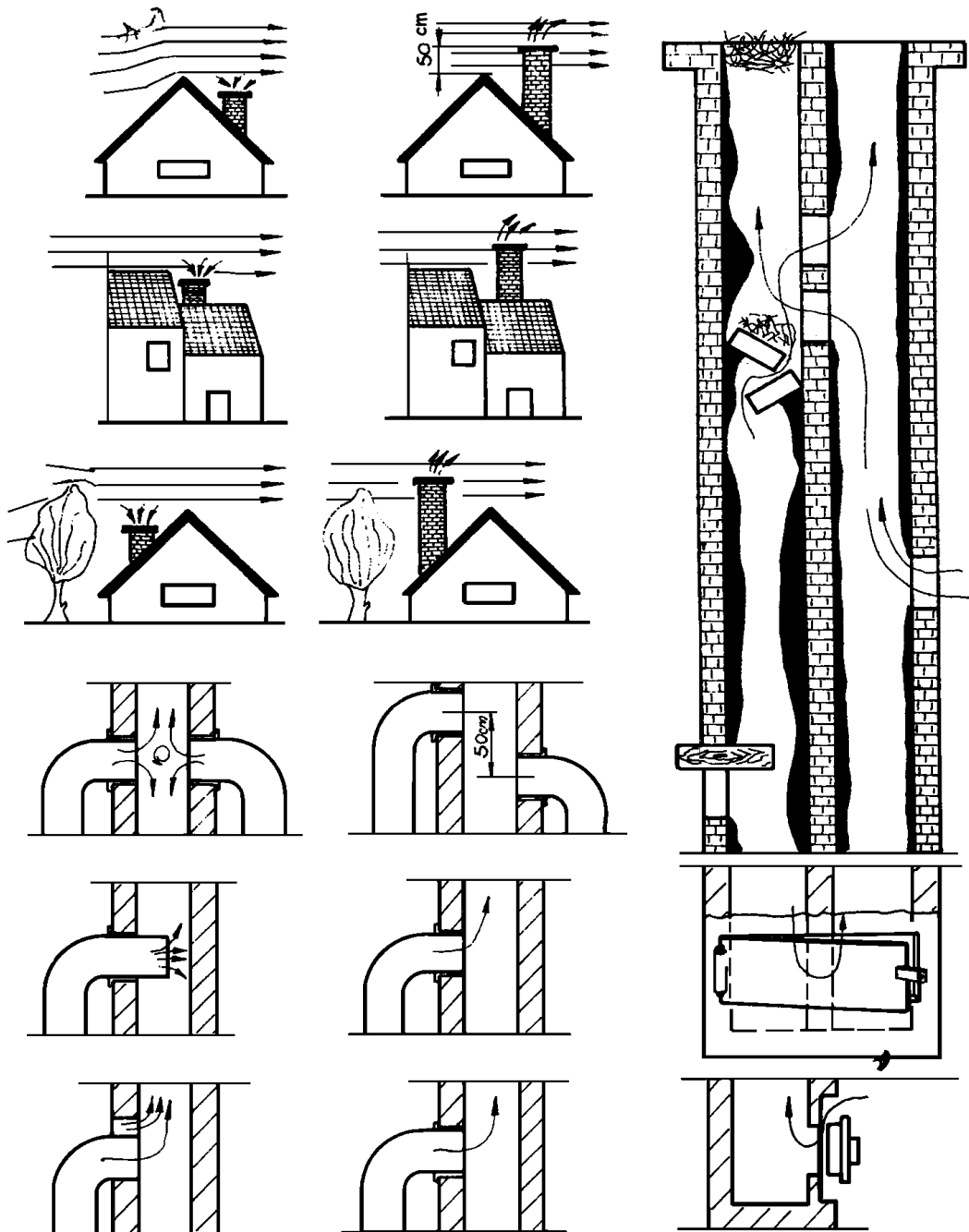

Figure 3

4. AIR REGULATION

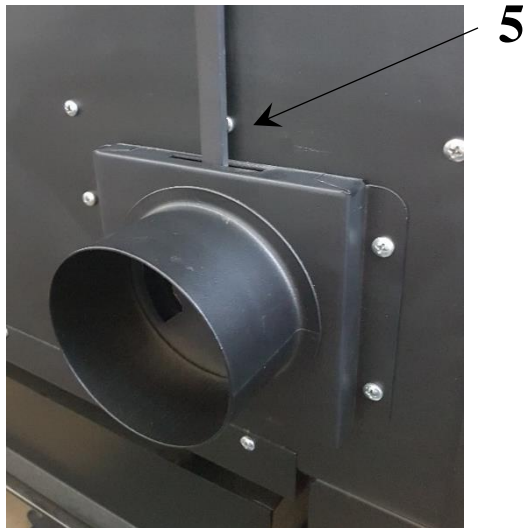

Figure 4

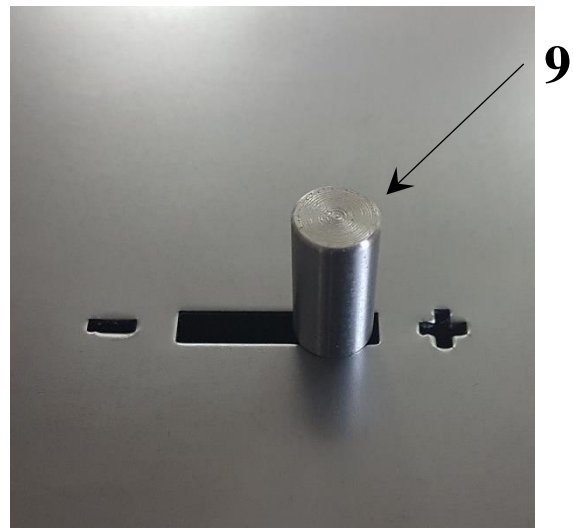

Figure 5

4.1. PRIMARY AIR

Primary combustion air, and thus the heating capacity of the stove, is determined through the primary air opening. That air is controlled on the ashtray support through the slide shutter for the primary combustion air (Figure 4, item 5).

The lever on the hotplate frame (figure 5, position 9) shows the direction for opening and closing the slide. For ignition, the air regulator must be opened to the maximum (place the lever into position +).

Note: To prevent overheating of the stove, a larger quantity of fuel than 2,5 kg dried wood per hour at adequately set air combustion is not allowed.

4.2. HEATING FLAP



Figure 6

Moving of the heating flap is performed by activating the knob (figure 3, position 11) which is positioned above the oven door. It is used for shortening of the path of flue gases during stoking. Open the heating flap only in a stage of kindling of the stove.

During stoking, if the heating flap is left open, it will cause overheating of the stove, thereby damaging the parts of the stove.

In addition, open heating flap results with bigger consumption of fuel.

Pull out the knob = the heating flap is open Push in the knob = the heating flap is closed

4.3. OVEN DOOR

The oven door can be in one of the two desired positions depending on the desired warmth in the room.

Over door open: higher heat emission for heating the room.

Oven door closed: lower heat emission for heating the room.

The oven door can be removed without tools: you should grab the handle and pull the slightly open door upwards. It can be placed back by inserting both hinges in the corresponding openings, at the front side of the oven and use pressure on the lower door edge with a knee, simultaneously lightly pulling the handle up.

When the stove is in operation, the oven door must be installed

4.4. Fuel drawer

In the lower part of the stove there is space for fuel, with guides and it is easy to lift it.

Attention: Do not store easily flammable materials such as paper etc. in that space. Pay attention to the height when filling.

5. STOVE COMMISSIONING

Prior to the first stoking, all enameled surfaces should be cleaned with a soft dry towel, in order to prevent creation of stains.

After becoming familiar with the handling of the stove, the first commissioning can take place. During the first stoking, open the window since the applied corrosion protection in a short time develops an unpleasant however insignificant smoke, that is, an unpleasant smell is created. This is normal and it disappears after a short time. Consider that some built-in parts of the stove (pipe for waste gases, door for filling etc.), when it is kindled, may be hot and represent danger of burns. Special attention should be paid to little children, so that no danger occurs.

At the first stoking, stoke the stove for two or three low fires in order to prevent cracking of the fireclay.

5.1. STOKING

- * Pull out the heating flap knob, the heating flap is open.
- * Open the primary air regulator at the highest level of air release (figure 3, position 9)
- * Open the firebox door
- * Insert wood wool, sawdust or paper
- * Over this, put 2-3 small wood pieces
- * Ignite
- * Close the door of the firebox
- * Let the wood burn lively
- * Press in the heating flap knob, the heating flap is closed.

Upon creating the basic ember, you need to add fuel in the opening for filling.

Position the air regulator on the appropriate marked position (put the knob in position 1-3).

When adding fuel, slightly open the door of the firebox without pulling out flue gases, in this manner you will avoid having flue gases in the room.

The rated heating capacity is achieved when you put the next fuel quantity and you adjust:

Type of solid fuel stove	Quantity	Time	Adjusting the primary air
Inox 75	1,77 kg	1,0 h	1/3

Make sure that you never put more wood or briquettes than what is really required for the rated capacity of heating.

The above indicated fuel quantity must not be exceeded because this may cause overheating of the stove.

Only natural dry wood may be used according to the regulations on emission protection. The wood being used must be dry (humidity residual, 20%). This is usually the case when wood is stored for two years in a dry spot where there is good ventilation. Wet wood has low calorific value and causes soot deposits in the flue channels and in the flue. Wood with treated upper surface (coated, painted, veneered and impregnated), plywood, waste of any kind (waste from packaging), plastics, paper, rubber, leather, textile etc. must not be stoked.

The combustion of such materials pollutes the environment and it is prohibited by law. Besides this, damages of the flue may also occur. In this case, all kinds of guarantee by the manufacturer cease. Unfavorable conditions and insufficient draught in the flue may cause obstructions so the flue gases are not entirely taken away. In this case you should create draught as a decoy in the flue. If this measure does not create draught in the flue, than it is not allowed to use the stove for safety reasons.

Note: Better usability of fuel, thereby better heating of space is established by slightly or completely opening the oven door.

5.2. COOKING

5.2.1. COOKING DURING SUMMER

During warm days, the stove on solid fuel is used mainly for cooking. The oven door is kept closed. The best is to use a pot with a heavy bottom and a corresponding cover.

5.2.2. COOKING DURING WINTER

During cold days, the solid fuel stove is used mostly for heating of rooms. In order to cook faster, use dry woods.

The heating flap must be closed and the air regulation must be maximally open.

After you finish cooking, you should put the air regulator in a position denoted for rated heat capacity.

5.3. BAKING COOKIES AND BAKING PASTRY

For baking cookies and baking pastry, evenly distributed heat is required.

In order to achieve this evenness and sufficiently high temperature, the oven must be closed with a closed heating flap, depending on what is being baked, the oven must be heated in advance. If the stove has heated up to the desired temperature, but what you plan to bake inside the oven. Do not let creation of very strong ember, you should rather frequently add fuel in small quantities.

Put high baking molds in the lower groove of the oven. You should bake all cookies with such shape on a moderate temperature. For flat cookies or pastry, both grooves may be used. During this, we recommend slightly higher oven temperature.

For baking pasta you need importantly higher temperature than when baking cookies. Hence, the time of preparation (with prior warming) is necessarily a bit longer.

6. REMOVAL OF SLAG AND ASH

Slag is removed with the supplied accessories, blades.

The ashtray should be emptied on a regular basis during every kindling.

You should clean the trash rack 1-2 times per week. If the air openings are clogged with slag, crust or some other burning remains, take out the trash rack and clean it.

6.1. OPENING FOR CLEANING



Fig. 7

Behind the protective cover of the opening for cleaning, there is a cover (figure 7 position 11).

It is fastened with a butterfly nut at the front side of the stove and in order to clean the internal part of the stove, it should be removed.

Before re-screwing it, you need a sealing braid which is on the cover in order to control the sealing, and if necessary, it should be changed.

6.2. MAINTENANCE AND CLEANING OF THE STOVE

Regular maintenance and care such as cleaning of the stove, the flue channels and flue extension is important for safe operation, thriftiness and preservation of the stove value.

Maintenance of enameled surfaces of the stove is recommended only in cold state.

The stove is cleaned with clean water and soft towel and in specific cases, with soap as well.

The cleaning intervals depend mostly on the use of fuel, the period of use of the stove and the manner of its use.

Unnecessary creation of dust may be avoided, if the following sequence of cleaning is maintained:

- * Removal of the cooking plate and thorough cleaning of the same outside.
- * Cleaning soot deposits from the upper side of the oven and in parts where flue gases pass.
- * Placing the plate.
- * Opening of the protective cover for cleaning (below the oven door) and removal of the cover.
- * Removal of soot and ash with a partitioning sheet metal.
- * Removal of soot and ash from the stove bottom.
- * Tightening the cover at the front side and closing the protective cover.

NOTE:

During stoking of the stove, make sure that the door glass of the firebox does not become smoky. Smoke is created due to bad combustion, for many reasons.

Bad draught of the flue (bad flue), the stove is improperly used, for example, the supply of oxygen is dampened too early. We cannot influence on these factors. For this reason we do not provide a guarantee for clean glass.

6.3. MAINTENANCE AND CLEANING OF THE COOKING PLATE

For cleaning of the cooking plate, use small sandpaper or abrasive. And during cleaning of the plate, wipe it with a semi-wet towel and in the end with a dry towel. Make sure that the stretching grooves on the cooking plate remain free with no crust, in order to enable stretching of the plate as an action of heat.

Baked food scraps or parts of slag in the grooves may cause deformation of the cooking panel.

Do not leave pots or pans on the cold cooking plate, edges may be created by corrosion, which are difficult to remove.

7. GENERAL NOTES

If you follow the instructions for installation and handling, the stove represents safe household appliance.

All drawbacks of Your stove can be removed at our customer service department.

For complaints related to mistakes which occur or drawbacks in terms of functionality, contact our customer service department. The same helps in the supply of spare parts (it uses only original parts). The entire stoking unit must be regularly inspected by an expert.